



**Submittal for
Single Wall
Spiral**



HRANEC SHEET METAL, INC.

SUBMITTAL Single Wall Spiral

INDEX

- 1 NOTES
- 2 CONNECTIONS
- 3 SPIRAL DUCT
- 4 GORE-LOCK ELBOWS
- 5 PRESSED ELBOWS
- 6 REDUCERS
- 7 TEES
- 8 CROSS TEE
- 9 SQUARE TO ROUND
- 10 SQUARE END SADDLE TAP
- 11 ROUND END SADDLE TAP
- 12 END CAPS
- 13 OFFSETS
- 14 VOLUME DAMPERS

SPECIAL NOTES:

1. RECOMMENDED MATERIAL FOR PAINTED SPIRAL DUCT=PAINT GRIP, HOWEVER GALVANIZED G90 CAN EASILY BE PAINTED WITH EXTRA PREP WORK.
2. WE RECOMMENDED WIPING DOWN MINIMAL EXCESS LUBRICANT TWICE BEFORE PAINTING WITH DRY RAGS. IN ADDITION,WIPE DOWN WITH NO RINSE PREPAINT CLEANER #13158 (SHERWIN WILLIAMS) BEFORE APPLYING TWO COATS METAL PRIMER.
3. ALL PRIMER AND PAINT SHOULD BE LABELED TO ADHERE VERY WELL FOR METAL PAINTING APPLICATIONS.
4. MANUFACTURED USING SPIRAL HELIX EQUIPMENT,THE NUMBER ONE LEADER IN SPIRAL MANUFACTURING EQUIPMENT.
5. OUR SPIRAL DUCT WORK HAS BEEN EXTENSIVELY AIR TESTED FOR LOW, MEDIUM & HIGH PRESSURES.
6. STANDARD MATERIAL GALVANIZED G90
ALTERNATE MATERIAL PAINT GRIP
ALTERNATE MATERIAL STAINLESS STEEL 304L,316
ALTERNATE MATERIAL ALUMINUM 3003
ALTERNATE MATERIAL PVC COATED
*(PVC IS NOT RECOMMENDED FOR EXPOSED DUCT THAT IS TO BE PAINTED DUE TO VARIATIONS IN COLORS)
7. METAL GAUGES ARE PRESSURE CLASS DRIVEN FROM LATEST SMACNA STANDARDS.
8. PROPER SEALING OF ALL COMPONENTS IS REQUIRED TO AVOID DARK AIR STREAKS AFTER INSTALLATION.
9. LONGITUDINAL SEAMS ARE ALL STITCH WELDED ON FITTINGS.

DESCRIPTION

NOTES



HRANEC SHEET METAL INC
SPIRAL MANUFACTURERS

CONNECTIONS FOR ROUND DUCT AND FITTINGS

**COUPLING
CONNECTION
SECURED WITH SCREWS AND SEALED**

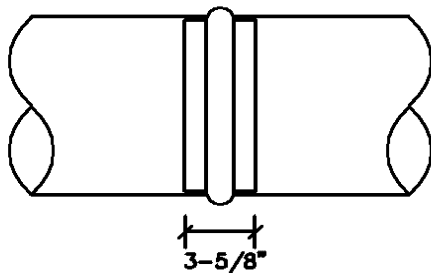

**SINGLE-WALL
FLANGE
SECURED WITH SCREWS AND SEALED**

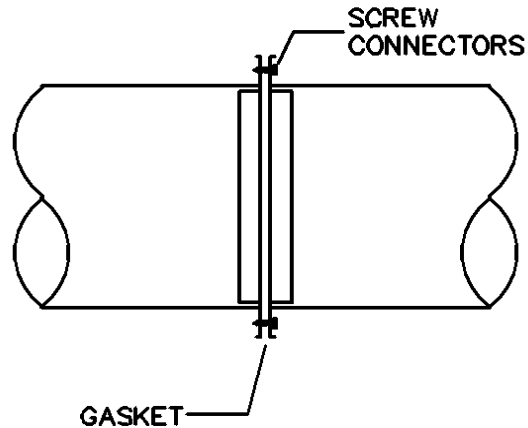

NOTES:

A. CONNECTIONS AVAILABLE.

1. COUPLING
2. SINGLE-WALL FLANGE
3. ANGLE RING
4. SPIRAL MATE WITH BAND IN LIEU OF SCREWS
5. BAND CLAMP (3 1/2" WIDE) PIPE & FITTINGS BUTT TOGETHER

B. COUPLING CONNECTIONS TO BE CAULKED AND SCREWED EVERY 10"

C. FLANGED CONNECTION TO BE GASKETED OR CAULKED AND SCREWED EVERY 10"

DESCRIPTION

CONNECTIONS



HRANEC SHEET METAL INC
SPIRAL MANUFACTURERS

SPIRAL DUCT

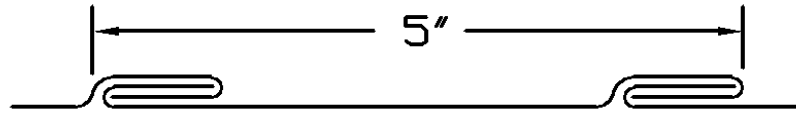

LATERAL SECTION OF 4-PLY PRESSURE PROOF
SPIRAL SEAM

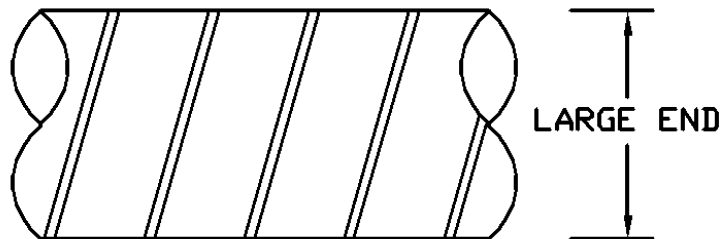

NOTES:

- A. AVAILABLE IN EVEN SIZES 4"Ø THROUGH 70"Ø
- B. AVAILABLE IN ODD SIZES 5"Ø, 7"Ø, & 9"Ø
- C. LENGTHS-6" THROUGH 240" (STANDARD 120")

DESCRIPTION

SPIRAL DUCT



HRANEC SHEET METAL INC
SPIRAL MANUFACTURERS

GORE-LOCK ELBOW

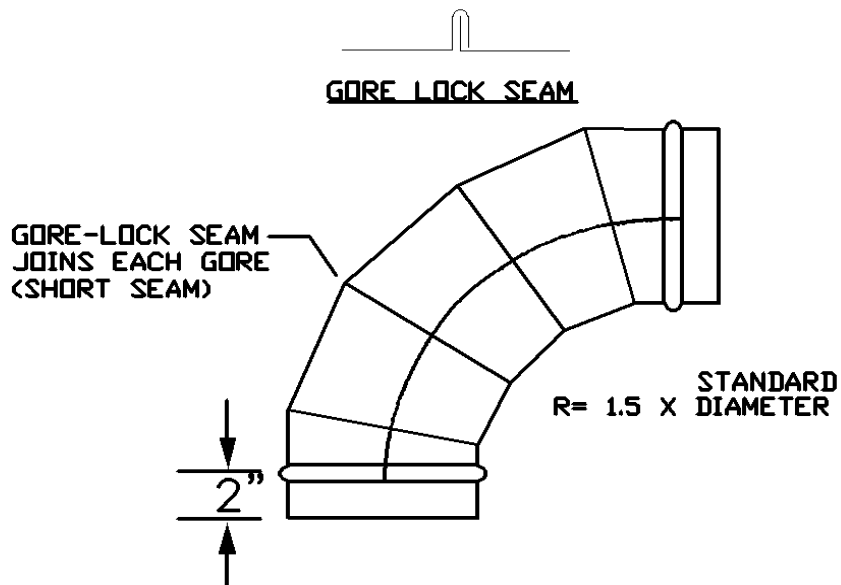

NOTES:

- A. AVAILABLE IN 5° THROUGH 90°
- B. STANDARD ELBOWS TO BE GORE LOCK CONSTRUCTION WITH 1/4" LAP STITCH WELD ON THE LONG SEAM.
- C. ALTERNATE CONSTRUCTION TACK & SEAL, AND FULLY WELDED.
- D. COUPLING CONNECTION SMALL END.
- E. FLANGED CONNECTIONS PIPE SIZE.
- F. MITERED ELBOW WITH VANES AVAILABLE WITH TACK & SEAL, TWO PIECE CONSTRUCTION.
- G. 16" AND BELOW=4 GORE CONSTRUCTION
- H. 18" AND ABOVE=5 GORE CONSTRUCTION

DESCRIPTION

GORE-LOCK ELBOW



HRANEC SHEET METAL INC
SPIRAL MANUFACTURERS

PRESSED ELBOWS

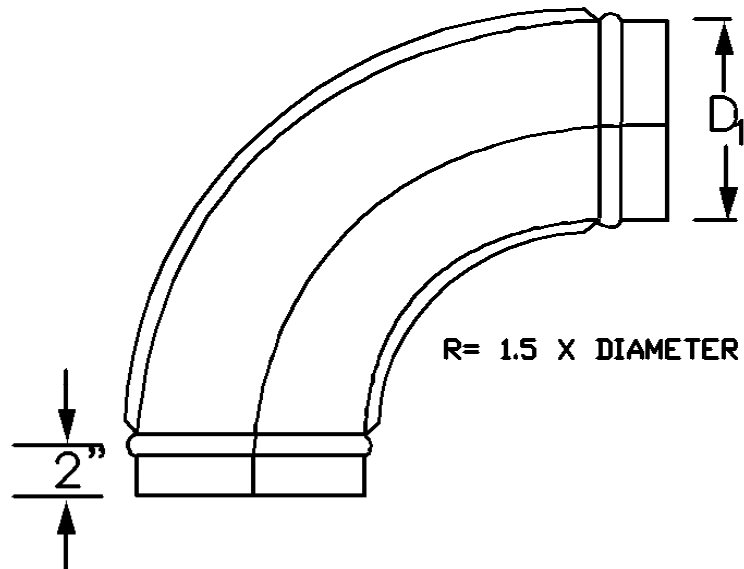

NOTES:

- A. 90° & 45° AVAILABLE
- B. STANDARD PRESSED ELBOW USED FOR SIZES 4"-5" UNLESS SPECIFIED OTHERWISE.
- C. 20 GAUGE GALVANIZED
- D. SMALL END TYPICAL (BOTH CONNECTIONS)

DESCRIPTION

PRESSED ELBOWS



HRANEC SHEET METAL INC
SPIRAL MANUFACTURERS

REDUCERS

CONCENTRIC REDUCER

$$X = \frac{D_1 - D_2}{2} \times 3$$

4" Minimum

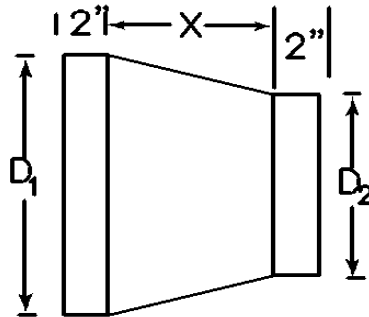

ECCENTRIC REDUCER

$$X = D_1 - D_2 \times 3$$

4" Minimum

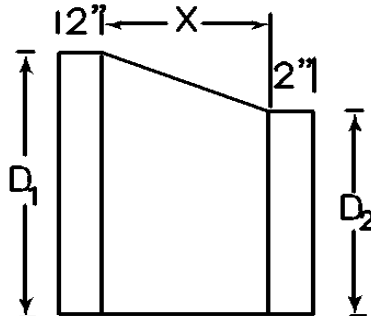

NOTES:

- A. GORE-LOCK SEAM AND 1/4" LAP STITCH WELD (LONGITUDINAL SEAM) USED ON REDUCERS
- B. COUPLING CONNECTION SMALL END.
- C. FLANGED CONNECTIONS PIPE SIZE.

DESCRIPTION

REDUCERS



HRANEC SHEET METAL INC
SPIRAL MANUFACTURERS

TEES

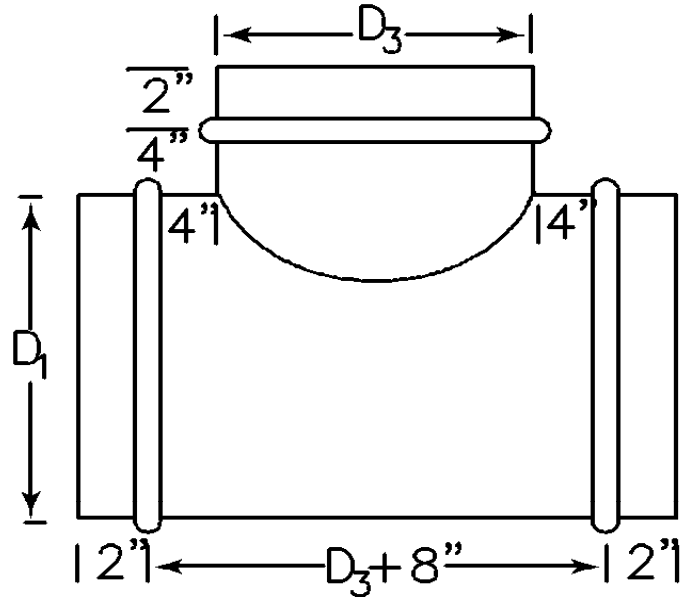

NOTES:

- A. SEALED, TACK WELDED SEAMS USED ON TEES.
- B. LONGITUDINAL SEAMS ARE ALL STITCH WELDED.
- C. COUPLING CONNECTION SMALL END.
- D. FLANGED CONNECTIONS PIPE SIZE.
- E. METAL IS 22 GAUGE UNLESS SPECIFIED OTHERWISE.
- F. LATERAL & REDUCING TEE'S AVAILABLE.
- G. MITERED TEE WITH VANES AVAILABLE WITH TACK & SEAL, TWO PIECE CONSTRUCTION.

DESCRIPTION

TEES



HRANEC SHEET METAL INC
SPIRAL MANUFACTURERS

CROSS TEE

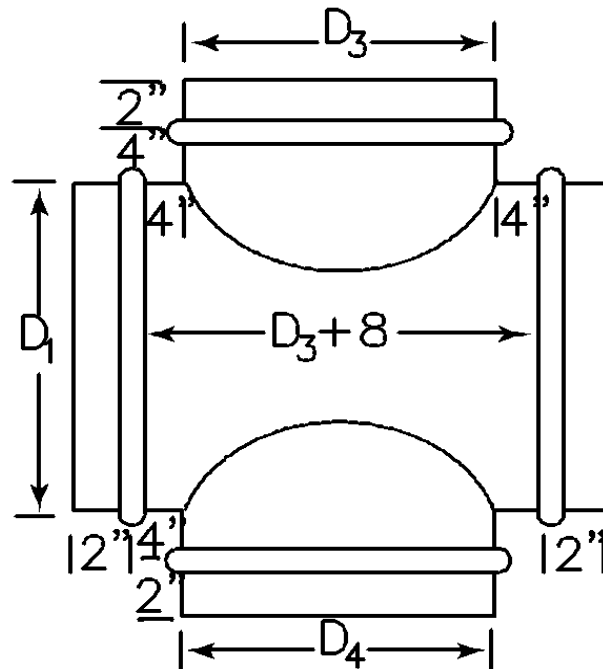

NOTES:

- A. SEALED, TACK WELDED SEAMS USED ON CROSSES.
- B. LONGITUDINAL SEAMS ARE ALL STITCH WELDED.
- C. COUPLING CONNECTION SMALL END.
- D. FLANGED CONNECTIONS PIPE SIZE.
- E. METAL IS 22 GAUGE UNLESS SPECIFIED OTHERWISE.
- F. LATERAL & REDUCING CROSSES AVAILABLE.

DESCRIPTION

CROSS TEE



HRANEC SHEET METAL INC
SPIRAL MANUFACTURERS

SQUARE to ROUND

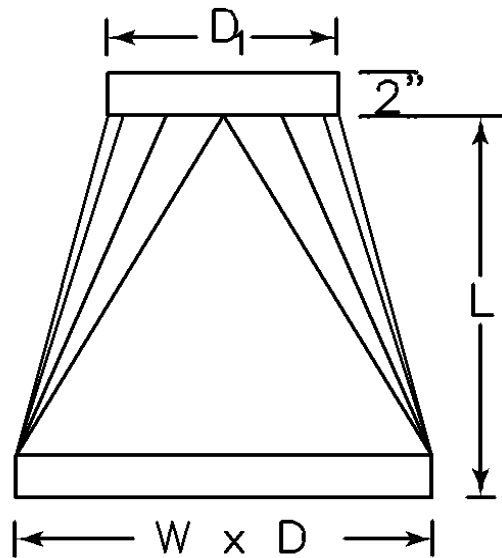

NOTES:

- A. SEALED, STITCH WELDED SEAMS USED ON SQUARE TO ROUNDS.
- B. COUPLING CONNECTION SMALL END.
- C. FLANGED CONNECTIONS PIPE SIZE.
- D. RECTANGULAR CONNECTIONS-
 - 1. RAW
 - 2. DUCTMATE 35
 - 3. FLANGE IN OR FLANGE OUT
 - 4. SLIP AND DRIVE

DESCRIPTION

SQUARE TO ROUND



HRANEC SHEET METAL INC
SPIRAL MANUFACTURERS

SQUARE END SADDLE TAP

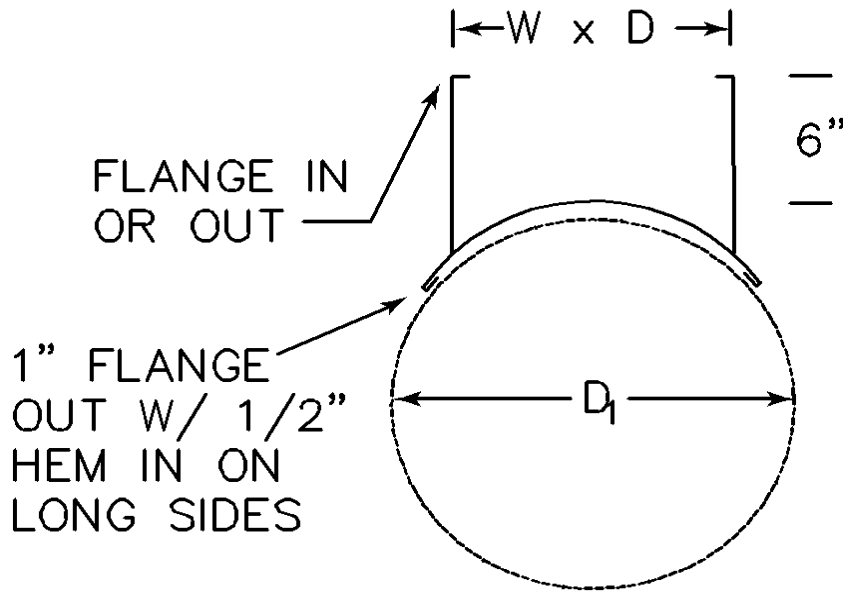

NOTES:

- A. SEALED, SPOT WELDED SEAMS USED ON REGISTER BOXES.
- B. STANDARD CONNECTION FLANGE IN.
- C. ALTERNATE CONNECTION FLANGE OUT. IF FLANGE OUT IS USED, SCREW THREADS ARE EXPOSED.
- D. FLANGE IN, BODY IS FACE SIZE OF REGISTER
- E. FLANGE OUT, BODY IS NECK SIZE OF REGISTER
- F. FITTING CAN ALSO HAVE AN END TREATMENT AS A DUCT CONNECTION SUCH AS SLIP AND DRIVE, TDC, OR DUCTMATE 35.

DESCRIPTION

SQUARE END SADDLE TAP



HRANEC SHEET METAL INC
SPIRAL MANUFACTURERS

ROUND END SADDLE TAP

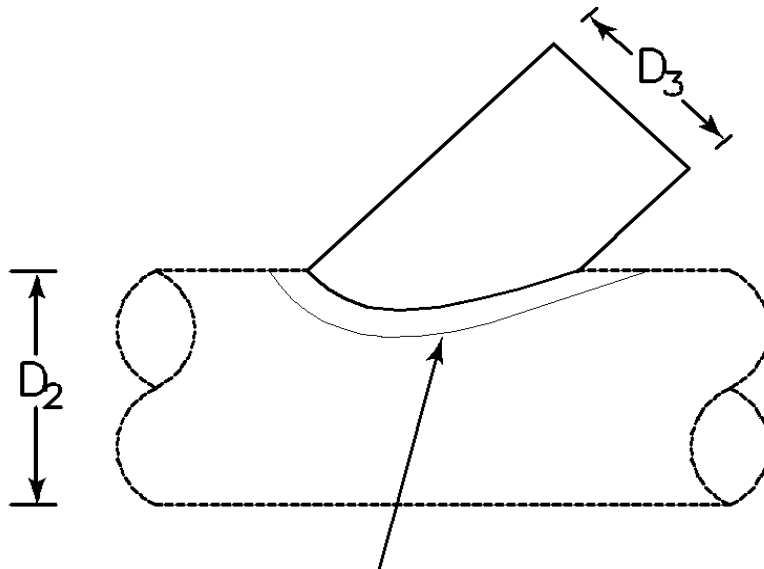

4"-16"= 1/2" FLANGE OUT
18" AND ABOVE= 2" PLATE WITH 1/2" HEM IN

NOTES:

- A. SEALED, STITCH WELDED SEAMS.
- B. COUPLING CONNECTION SMALL END.
- C. FLANGED CONNECTIONS PIPE SIZE.
- D. STANDARD 45° & 90° ANGLES. ALTERNATE ANGLES AVAILABLE.
- E. CONICAL OR BELLMOUTH AVAILABLE.

DESCRIPTION

ROUND END SADDLE TAP



HRANEC SHEET METAL INC
SPIRAL MANUFACTURERS

END CAPS

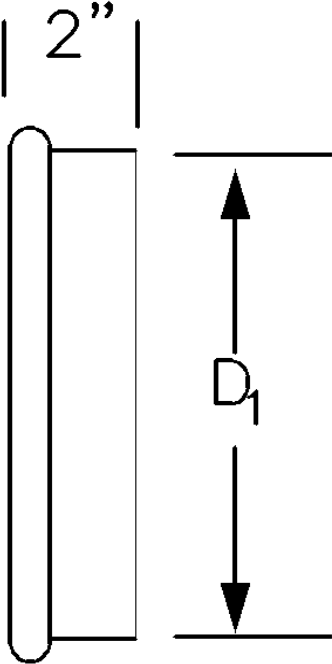

NOTE:
A. GORE LOCK CONSTRUCTION

DESCRIPTION
END CAPS



HRANEC SHEET METAL INC SPIRAL MANUFACTURERS
--

OFFSETS

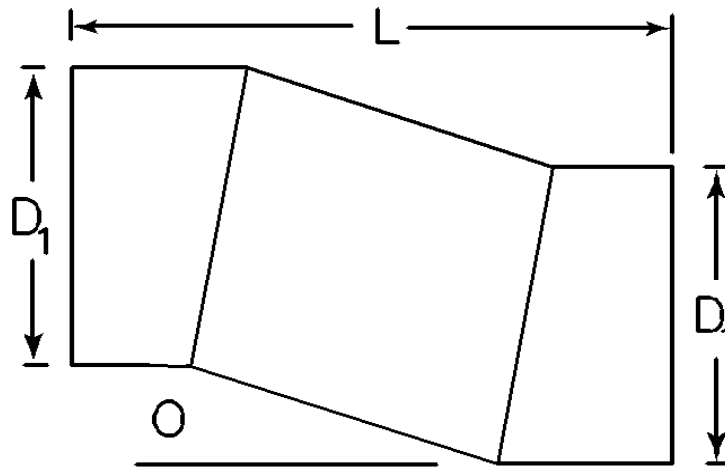

NOTES:

- A. LENGTH TWO OR THREE TIMES THE OFFSET
- B. GORE-LOCK SEAM AND STITCH WELD ON LONG SEAM
- C. COUPLING CONNECTION SMALL END.
- D. FLANGED CONNECTIONS PIPE SIZE.

DESCRIPTION

OFFSETS



HRANEC SHEET METAL INC
SPIRAL MANUFACTURERS

VOLUME DAMPERS

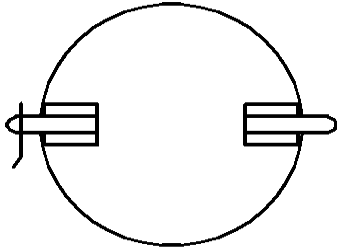

- FOR DAMPERS 18"Ø AND SMALLER HARDWARE IS HAMMERED TO DAMPER BLADE.
- RUBBER GROMMETS AVAILABLE FOR AIR-TIGHT SEAL

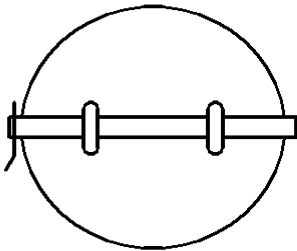

- FOR DAMPERS 20"Ø AND LARGER.
- 1/2" BAR U-BOLTED TO DAMPER BLADE.
- RUBBER GROMMETS AVAILABLE FOR AIR-TIGHT SEAL

DESCRIPTION

VOLUME DAMPERS



HRANEC SHEET METAL INC
SPIRAL MANUFACTURERS