



**Submittal for
Double Wall
Oval**



HRANEC SHEET METAL, INC.

SUBMITTAL

Double Wall Oval

INDEX

- 1 NOTES
- 2 CONNECTIONS
- 3 DOUBLE WALL OVAL DUCT
- 4 DOUBLE WALL TACK & SEAL ELBOW
- 5 REDUCERS
- 6 TEES
- 7 CROSSES
- 8 SQUARE TO OVAL
- 9 ROUND TO OVAL
- 10 SQUARE END SADDLE TAP
- 11 ROUND or OVAL END SADDLE TAPS
- 12 END CAPS
- 13 OFFSETS
- 14 VOLUME DAMPERS

SPECIAL NOTES:

1. RECOMMENDED MATERIAL FOR PAINTED OVAL DUCT IS PAINT GRIP, HOWEVER GALVANIZED G90 CAN EASILY BE PAINTED WITH EXTRA PREP WORK.
2. WE RECOMMENDED WIPING DOWN MINIMAL EXCESS LUBRICANT TWICE BEFORE PAINTING WITH DRY RAGS. IN ADDITION, WIPE DOWN WITH NO RINSE PREPAINT CLEANER #13158 (SHERWIN WILLIAMS) BEFORE APPLYING TWO COATS METAL PRIMER.
3. ALL PRIMER AND PAINT SHOULD BE LABELED TO ADHERE VERY WELL FOR METAL PAINTING APPLICATIONS.
4. MANUFACTURED USING SPIRAL HELIX EQUIPMENT THE NUMBER ONE LEADER IN OVAL MANUFACTURING EQUIPMENT.
5. OUR OVAL DUCT WORK HAS BEEN EXTENSIVELY AIR TESTED FOR LOW, MEDIUM & HIGH PRESSURES.
6. STANDARD MATERIAL OUTER WALL GALVANIZED G90 INNER WALL PERFORATED GALVANIZED G90
ALTERNATE MATERIAL PAINT GRIP
ALTERNATE MATERIAL STAINLESS STEEL 304L, 316
ALTERNATE MATERIAL ALUMINUM 3003
ALTERNATE MATERIAL PVC COATED
*(PVC IS NOT RECOMMENDED FOR EXPOSED DUCT THAT IS TO BE PAINTED DUE TO VARIATIONS IN COLORS)
7. METAL GAUGES ARE PRESSURE CLASS DRIVEN FROM LATEST SMACNA STANDARDS.
8. PROPER SEALING OF ALL COMPONENTS IS REQUIRED TO AVOID DARK AIR STREAKS AFTER INSTALLATION.
9. 1' & 2' DOUBLE WALL AVAILABLE.
10. LONGITUDINAL SEAMS ARE ALL STITCH WELDED ON FITTINGS.
11. STANDARD INNER MATERIAL FOR STRAIGHT JOINTS IS PERFORATED. INNER MATERIAL FOR FITTINGS IS SOLID.

DESCRIPTION

NOTES



HRANEC SHEET METAL INC
SPIRAL MANUFACTURERS

CONNECTIONS FOR DOUBLE WALL OVAL DUCT AND FITTINGS

COUPLING
CONNECTION
SECURED WITH SCREWS AND SEALED

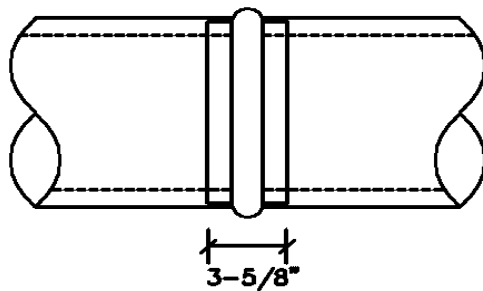

DOUBLE-WALL
FLANGE
SECURED WITH SCREWS AND SEALED

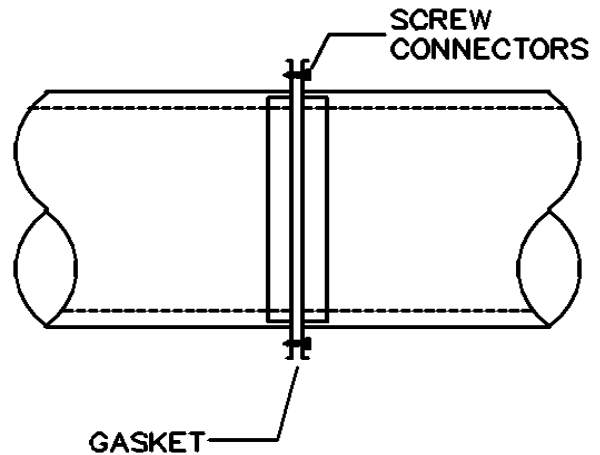

NOTES:

A. CONNECTIONS AVAILABLE.

1. COUPLING (WITH OR WITHOUT RUBBER GASKET)

2. DOUBLE-WALL FLANGE

3. SINGLE-WALL FLANGE WITH BAND CLAMP

B. COUPLING CONNECTIONS TO BE CAULKED

C. FLANGED CONNECTION TO BE GASKETED OR CAULKED

D. WHEN USING COUPLING CONNECTION, THE INNER COUPLING CONNECTION TO BE SLIP FIT AND SCREWED. THE OUTER COUPLING CONNECTION TO BE SLIP FIT AND SCREWED.

DESCRIPTION

CONNECTIONS



HRANEC SHEET METAL INC
SPIRAL MANUFACTURERS

DOUBLE WALL OVAL DUCT

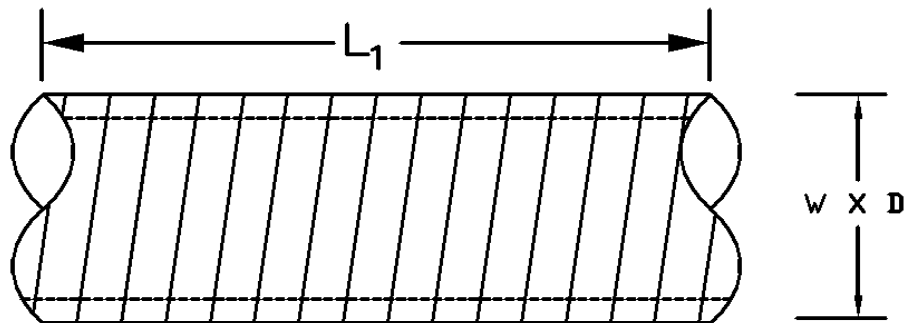
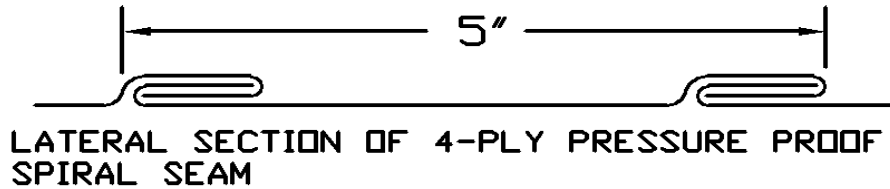

- LENGTHS-6" THROUGH 120"
- AVAILABLE IN SIZES LISTED BELOW (ID)

21.8 x 6	23.8 x 8	22.7 x 10	21.5 x 12	20.3 x 14	22.3 x 16	21.2 x 18	23.2 x 20	25.2 x 22
25.0 x 6	27.0 x 8	25.8 x 10	24.7 x 12	23.5 x 14	25.5 x 16	24.3 x 18	26.3 x 20	28.3 x 22
28.1 x 6	30.1 x 8	29.0 x 10	27.8 x 12	26.7 x 14	28.7 x 16	27.5 x 18	29.5 x 20	31.5 x 22
31.3 x 6	33.3 x 8	32.1 x 10	31.0 x 12	29.8 x 14	31.8 x 16	30.7 x 18	32.7 x 20	34.7 x 22
34.5 x 6	36.5 x 8	35.3 x 10	34.1 x 12	33.0 x 14	35.0 x 16	33.8 x 18	35.8 x 20	37.8 x 22
37.6 x 6	39.6 x 8	38.5 x 10	37.3 x 12	36.1 x 14	38.1 x 16	37.0 x 18	39.0 x 20	41.0 x 22
40.8 x 6	42.8 x 8	41.6 x 10	40.5 x 12	39.3 x 14	41.3 x 16	40.1 x 18	42.1 x 20	44.1 x 22
44.0 x 6	46.0 x 8	44.8 x 10	43.6 x 12	42.5 x 14	44.5 x 16	43.3 x 18	45.3 x 20	47.3 x 22
47.1 x 6	49.1 x 8	48.0 x 10	46.8 x 12	45.6 x 14	47.6 x 16	46.5 x 18	48.5 x 20	50.5 x 22
50.3 x 6	52.3 x 8	51.1 x 10	50.0 x 12	48.8 x 14	50.8 x 16	49.6 x 18	51.6 x 20	53.6 x 22
53.5 x 6	55.5 x 8	54.3 x 10	53.1 x 12	52.0 x 14	54.0 x 16	52.8 x 18	54.8 x 20	56.8 x 22
56.6 x 6	58.6 x 8	57.5 x 10	56.3 x 12	55.1 x 14	57.1 x 16	56.0 x 18	58.0 x 20	60.0 x 22
59.8 x 6	61.8 x 8	60.6 x 10	59.5 x 12	58.3 x 14	60.3 x 16	59.1 x 18	61.1 x 20	63.1 x 22
62.9 x 6	64.9 x 8	63.8 x 10	62.6 x 12	61.5 x 14	63.5 x 16	62.3 x 18	64.3 x 20	66.3 x 22
66.1 x 6	68.1 x 8	66.9 x 10	65.8 x 12	64.6 x 14	66.6 x 16	65.5 x 18	67.5 x 20	69.5 x 22
69.3 x 6	71.3 x 8	70.1 x 10	68.9 x 12	67.8 x 14	69.8 x 16	68.6 x 18	70.6 x 20	72.6 x 22
72.4 x 6	74.4 x 8	73.3 x 10	72.1 x 12	70.9 x 14	72.9 x 16	71.8 x 18	73.8 x 20	75.8 x 22
75.6 x 6	77.6 x 8	76.4 x 10	75.3 x 12	74.1 x 14	76.1 x 16	74.9 x 18	76.9 x 20	78.9 x 22
78.8 x 6	80.8 x 8	79.6 x 10	78.4 x 12	77.3 x 14	79.3 x 16	78.1 x 18	80.1 x 20	
				80.4 x 14		81.3 x 18		

DESCRIPTION

DOUBLE WALL OVAL DUCT



HRANEC SHEET METAL INC
SPIRAL MANUFACTURERS

DOUBLE WALL TACK & SEAL ELBOW

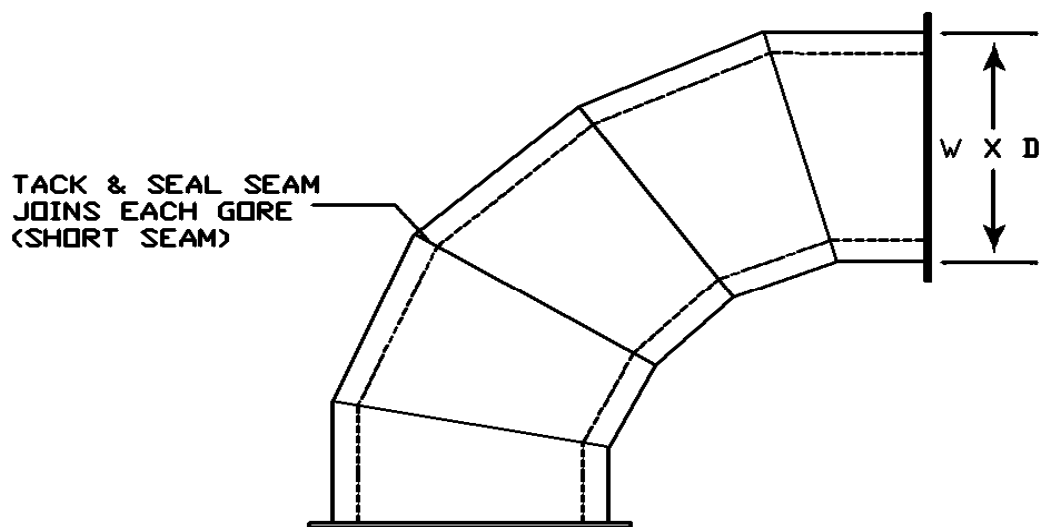

NOTES:

- A. STANDARD ELBOWS TO BE TACK & SEAL CONSTRUCTION WITH 1/4" LAP ON THE LONG SEAM.
- B. ALTERNATE CONSTRUCTION FULLY WELDED.
- C. COUPLING CONNECTION SMALL END.
- D. FLANGED CONNECTIONS PIPE SIZE.
- E. MITERED ELBOW WITH VANES AVAILABLE WITH TACK & SEAL, TWO PIECE CONSTRUCTION.
- F. 16" MINOR AND BELOW=4 GORE CONSTRUCTION
- G. 18" MINOR AND ABOVE=5 GORE CONSTRUCTION

DESCRIPTION

DOUBLE WALL TACK & SEAL
ELBOW



HRANEC SHEET METAL INC
SPIRAL MANUFACTURERS

DOUBLE WALL REDUCERS

CONCENTRIC REDUCER

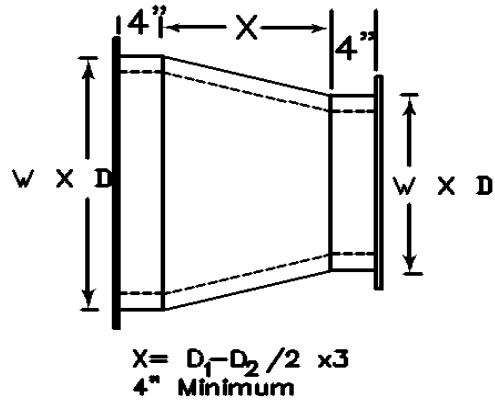

ECCENTRIC REDUCER

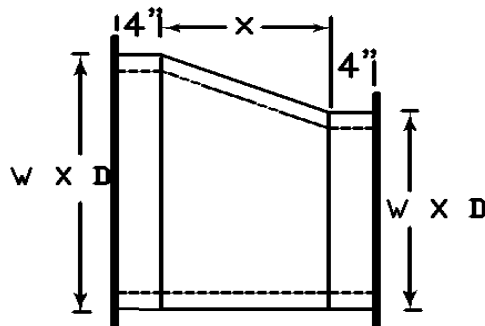

NOTES:

- A. TACK & SEAL CONSTRUCTION USED ON REDUCERS
- B. COUPLING CONNECTION SMALL END.
- C. FLANGED CONNECTIONS PIPE SIZE.

DESCRIPTION
REDUCERS



HRANEC SHEET METAL INC SPIRAL MANUFACTURERS
--

DOUBLE WALL TEES

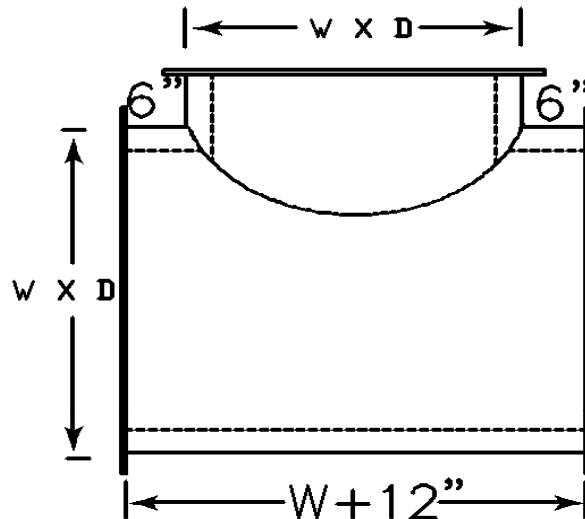

NOTES:

- A. SEALED, SPOT WELDED SEAMS USED ON TEES.
- B. COUPLING CONNECTION SMALL END.
- C. FLANGED CONNECTIONS PIPE SIZE.
- D. METAL IS 22 GAUGE UNLESS SPECIFIED OTHERWISE.
- E. DOUBLE WALL LATERAL & REDUCING TEE'S AVAILABLE.
- F. DOUBLE WALL MITERED TEE WITH VANES AVAILABLE WITH TACK & SEAL, TWO PIECE CONSTRUCTION.
- G. LONGITUDINAL SEAMS ARE ALL STITCH WELDED.

DESCRIPTION

TEES



HRANEC SHEET METAL INC
SPIRAL MANUFACTURERS

DOUBLE WALL CROSSES

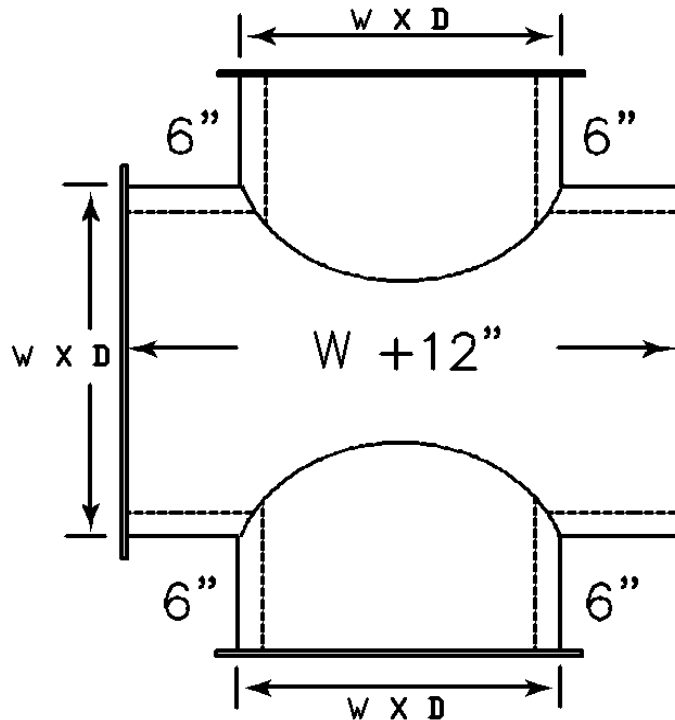

NOTES:

- A. SEALED, SPOT WELDED SEAMS USED ON CROSSES.
- B. COUPLING CONNECTION SMALL END.
- C. FLANGED CONNECTIONS PIPE SIZE.
- D. METAL IS 22 GAUGE UNLESS SPECIFIED OTHERWISE.
- E. LATERAL & REDUCING DOUBLE WALL CROSSES AVAILABLE.
- F. LONGITUDINAL SEAMS ARE ALL STITCH WELDED.

DESCRIPTION

CROSSES



HRANEC SHEET METAL INC
SPIRAL MANUFACTURERS

DOUBLE WALL SQUARE
to OVAL

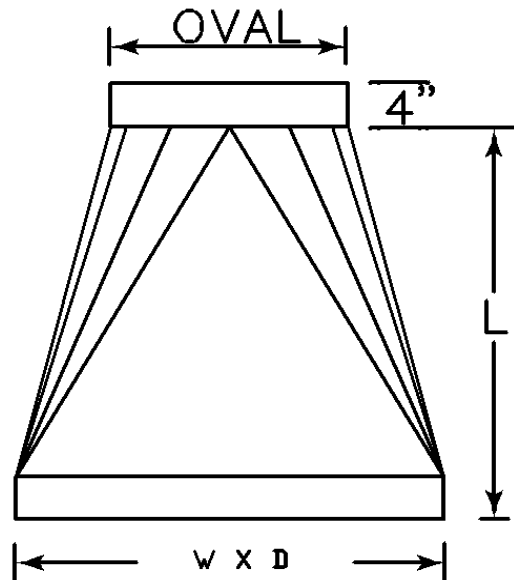

NOTES:

- A. SEALED, SPOT WELDED SEAMS USED ON SQUARE TO OVAL.
- B. COUPLING CONNECTION SMALL END.
- C. FLANGED CONNECTIONS PIPE SIZE.
- D. DUCTMATE 35 USED ON RECTANGULAR END.
- E. FITTING CAN ALSO BE USED AS A REGISTER CONNECTION WITH A FLANGE IN OR OUT.
- F. LONGITUDINAL SEAMS ARE ALL STITCH WELDED.

DESCRIPTION

SQUARE TO OVAL



HRANEC SHEET METAL INC
SPIRAL MANUFACTURERS

DOUBLE WALL
ROUND to OVAL

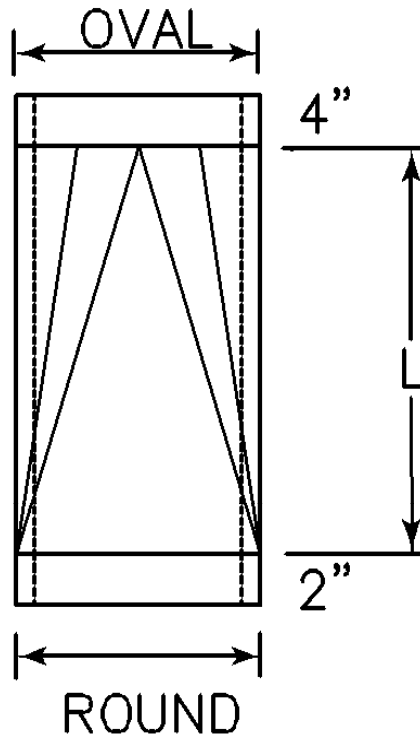

NOTES:

- A. SEALED, SPOT WELDED SEAMS USED ON OVAL TO ROUNDS.
- B. COUPLING CONNECTION SMALL END.
- C. FLANGED CONNECTIONS PIPE SIZE.
- D. LONGITUDINAL SEAMS ARE ALL STITCH WELDED.

DESCRIPTION

ROUND TO OVAL



HRANEC SHEET METAL INC
SPIRAL MANUFACTURERS

DOUBLE WALL SQUARE END
SADDLE TAP

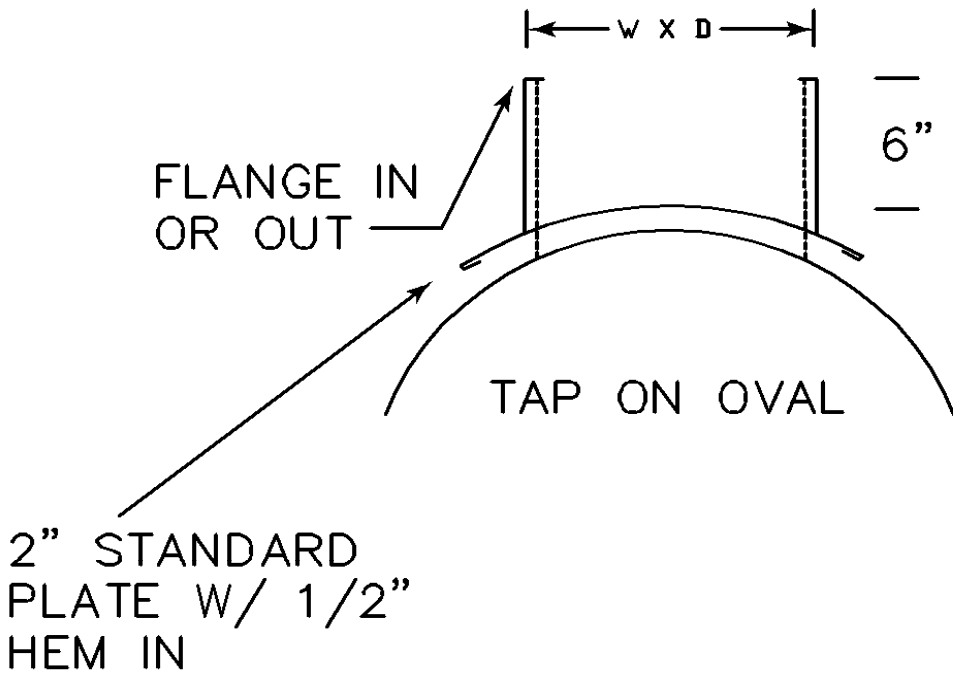

NOTES:

- A. SEALED, SPOT WELDED SEAMS USED ON REGISTER BOXES.
- B. STANDARD CONNECTION FLANGE IN.
- C. ALTERNATE CONNECTION FLANGE OUT. IF FLANGE OUT IS USED, SCREW THREADS ARE EXPOSED.
- D. FLANGE IN, BODY IS FACE SIZE OF REGISTER
- E. FLANGE OUT, BODY IS NECK SIZE OF REGISTER
- F. FITTING CAN ALSO HAVE AN END TREATMENT AS A DUCT CONNECTION SUCH AS S&D, TDC, OR DUCTMATE 35.

DESCRIPTION

SQUARE END SADDLE TAP



HRANEC SHEET METAL INC
SPIRAL MANUFACTURERS

DOUBLE WALL ROUND OR OVAL END SADDLE TAP

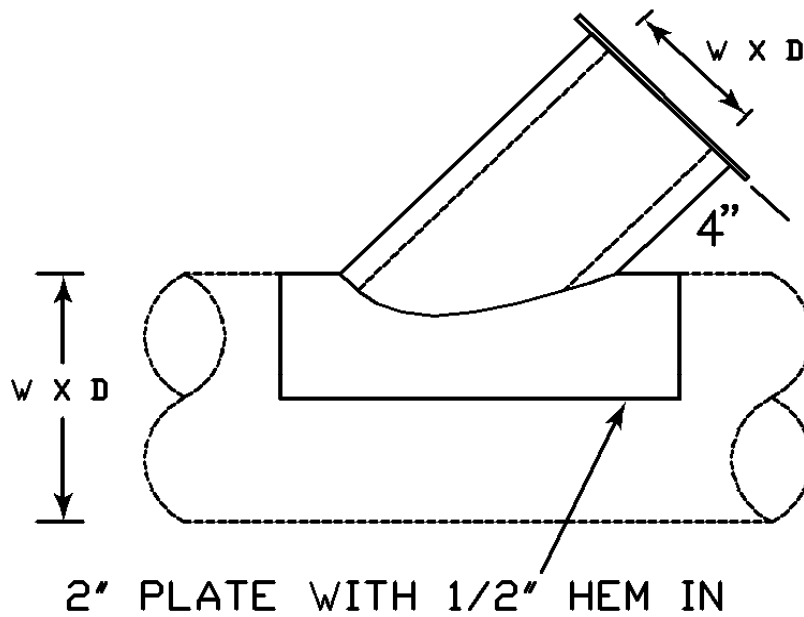

NOTES:

- A. SEALED, STITCH WELDED SEAMS.
- B. COUPLING CONNECTION SMALL END.
- C. FLANGED CONNECTIONS PIPE SIZE.
- D. STANDARD 45° & 90° ANGLES. ALTERNATE ANGLES MAY BE AVAILABLE.
- E. CONICAL OR BELLMOUTH AVAILABLE.

DESCRIPTION

ROUND or OVAL END
SADDLE TAPS



HRANEC SHEET METAL INC
SPIRAL MANUFACTURERS

DOUBLE WALL
END CAPS

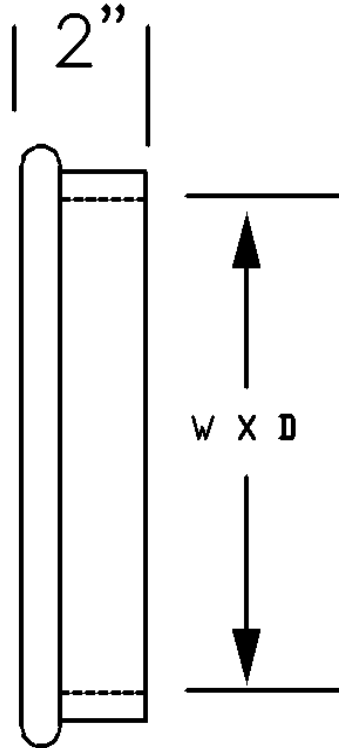

- TACK & SEAL CONSTRUCTION

DESCRIPTION

END CAPS



HRANEC SHEET METAL INC
SPIRAL MANUFACTURERS

DOUBLE WALL OFFSETS

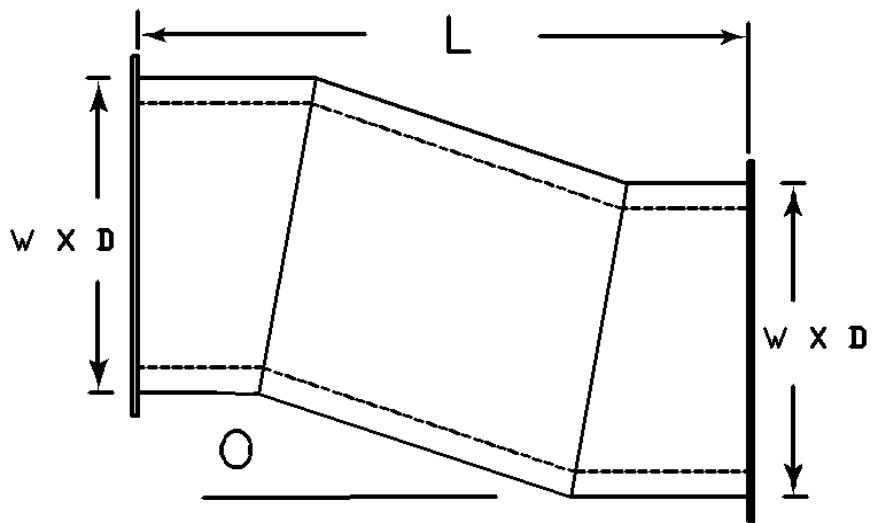

NOTES:

- A. LENGTH TWO - THREE TIMES THE OFFSET
- B. TACK & SEAL CONSTRUCTION USED ON REDUCERS
- C. COUPLING CONNECTION SMALL END.
- D. FLANGED CONNECTIONS PIPE SIZE.

DESCRIPTION

OFFSETS



HRANEC SHEET METAL INC
SPIRAL MANUFACTURERS

VOLUME DAMPERS

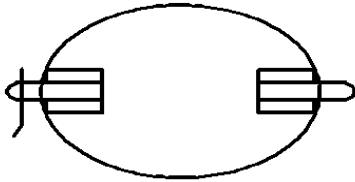

- FOR DAMPERS 40X20 AND SMALLER.
- HARDWARE IS HAMMERED TO DAMPER BLADE.
- RUBBER GROMMETS AVAILABLE FOR AIR-TIGHT SEAL

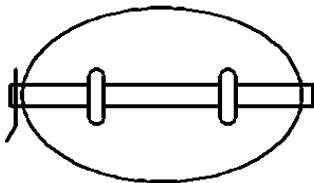

- FOR DAMPERS 40X20 AND LARGER.
- 1/2" BAR U-BOLTED TO DAMPER BLADE.
- RUBBER GROMMETS AVAILABLE FOR AIR-TIGHT SEAL

DESCRIPTION

VOLUME DAMPERS



HRANEC SHEET METAL INC
SPIRAL MANUFACTURERS